

### Thiele-Small Parameters

Qms	3.44	
Qes	0.91	
Qts	0.72	
Mms	11.42	g
Vas	10.05	l
Cms	0.39	mm/N
Xmax	4.15	mm
u0	0.45	%
Sd	134.78	cm <sup>2</sup>
Bl	4.52	T*m
Rms	0.64	Kg/s

### Electrical Characteristics

Nominal Impedance	4	Ohm ± 12%
Rated Power DIN 45573	80*	Watt
Rated Power DIN 45500	160	Watt
Resonance Frequency	75	Hz ± 6 Hz
Flux Density	9500	Gauss ± 7%
Voice Coil Resistance	3.4	Ohm ± 10%
Voice Coil Diameter	25.45	mm
Sensitivity (1w, 1m)	89.00	dB
Voice Coil Induc. (1KHz.)	0.156	mH



### Measurement Conditions

Frequency Response: The Speaker is Mounted On a DIN 45575 Baffle.

Microphone Distance: 1m.

Measuring Power, Held Costantly, is 1 Watt Across a DC Resistance of Normal Imped.

## LOUDSPEAKER

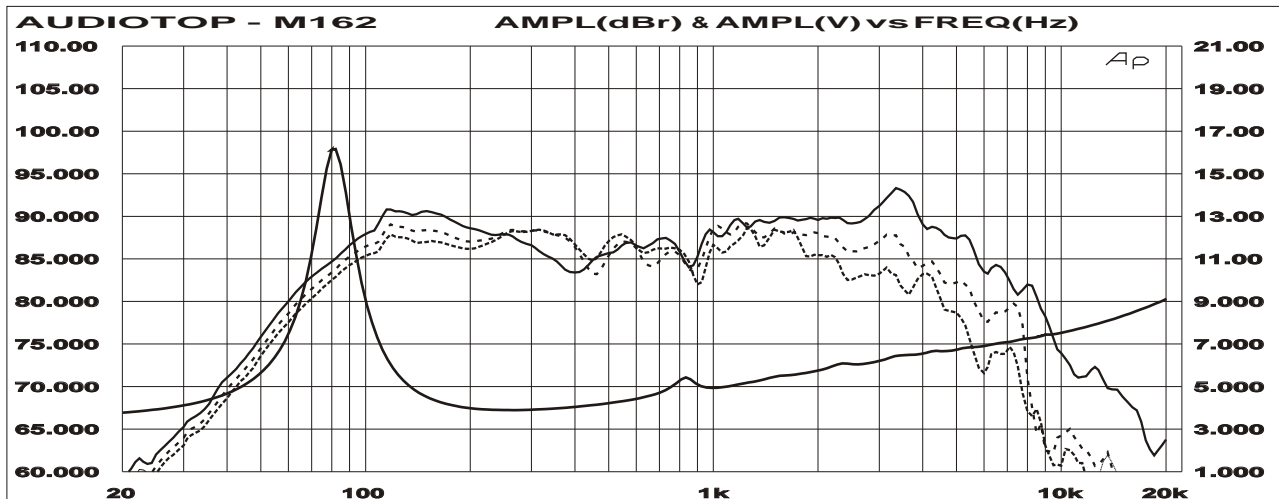

FREQUENCY RESPONSE AND IMPEDANCE : also to 30° and to 45°

NOTES: Polipropilene cone, rubber surround aluminium voice coil former and aluminium ogiva on the nucleo.

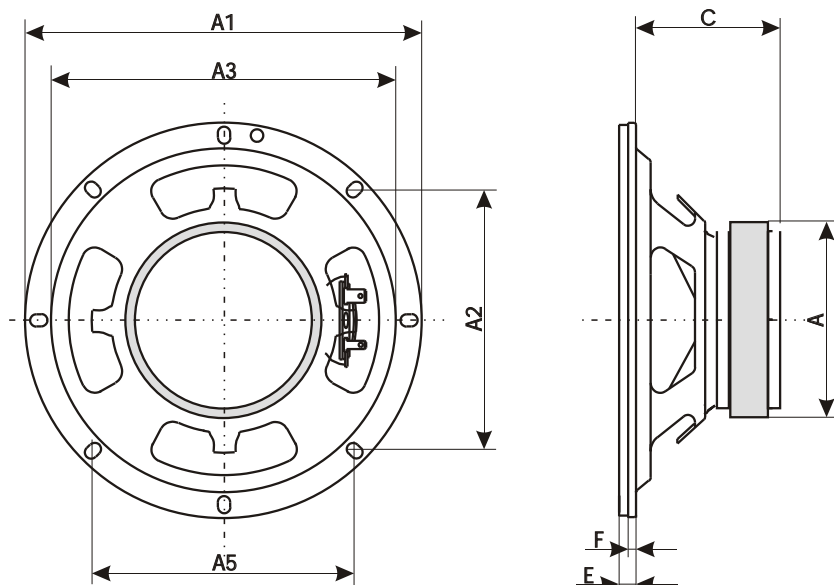

A	→	86 mm.
A1	→	164 mm.
A2	→	109 mm.
A3	→	144 mm.
A4	→	--- mm.
A5	→	109 mm.
A6	→	--- mm.
B	→	92 mm.
C	→	66 mm.
D	→	--- mm.
E	→	8,5 mm.
F	→	5 mm.
G	→	--- mm.